

PARTS LIST, COUNTER CONVECTION STEAMERS  
MODELS SN-3E, SN-4E, SN-5E



COUNTER CONVECTION STEAMERS  
BLODGETT MODELS: SN-3E  
SN-4E



June 3, 2010  
**BLODGETT OVEN CO** ▪ 44 lakeside Ave ▪ Burlington, VT 05446  
Tel. 800-331-5842 ▪ Fax 802-860-3732 ▪ [www.blodgett.com](http://www.blodgett.com)

PARTS LIST, COUNTER CONVECTION STEAMERS  
MODELS SN-3E, SN-4E, SN-5E

**GENERAL ASSEMBLY**

**FIGURE 1**

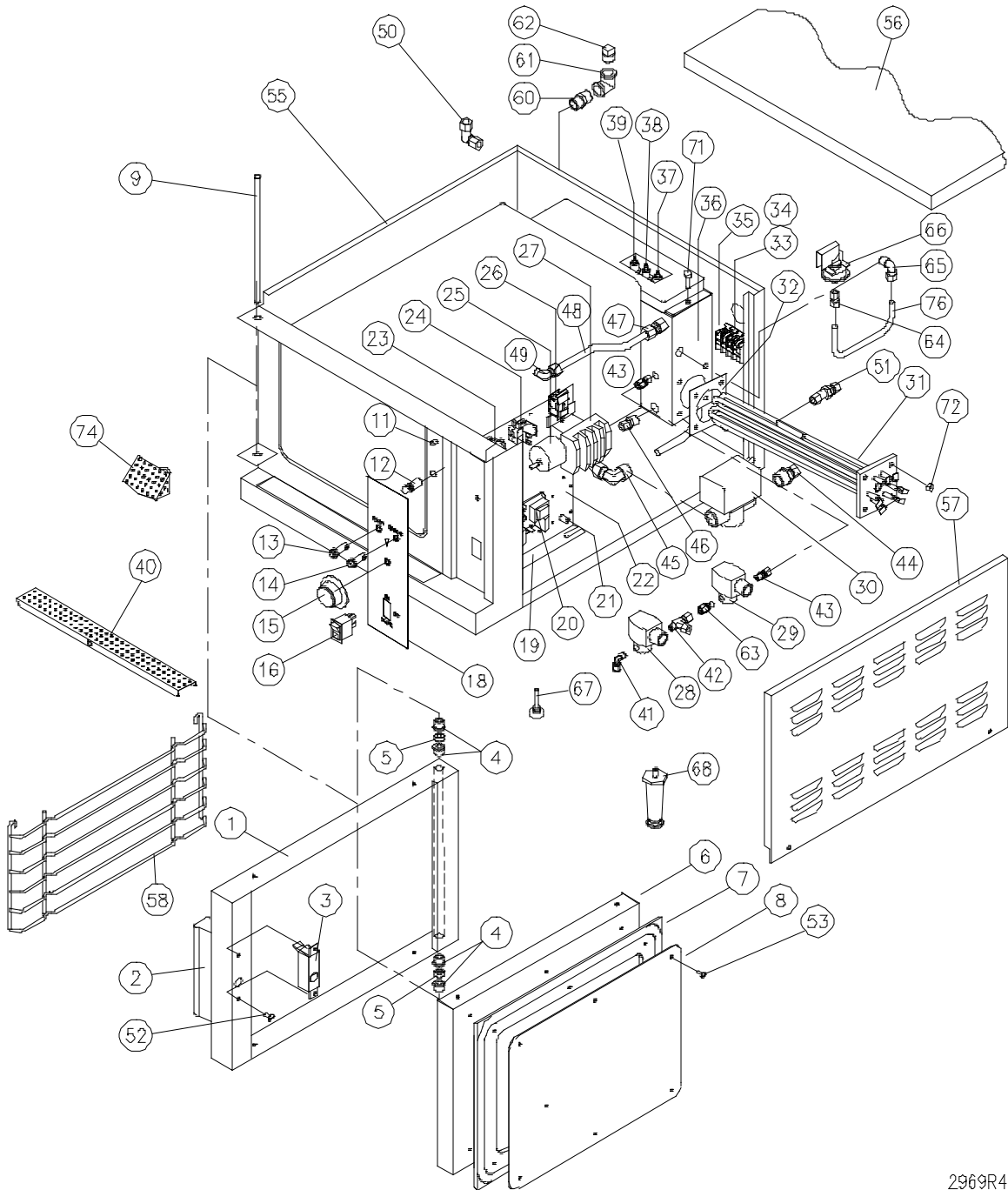

2969R4

PARTS LIST, COUNTER CONVECTION STEAMERS  
MODELS SN-3E, SN-4E, SN-5E

	<u>ITEM</u>	<u>Part #</u>	<u>DESCRIPTION</u>	<u>3</u>	<u>4</u>	<u>5</u>
	1A	42678	Door Assembly	1		
		42680	Door Assembly		1	
		42682	Door Assembly			1
	1	42638	Door Frame	1		
		42639	Door Frame		1	
		42641	Door Frame			1
	2	42454	Door Handle Assembly	1	1	1
*		42258	Decal	1	1	1
*		42453	Door Handle	1	1	1
*		42705	Door Handle Plate	1	1	1
*		40090	Socket Set Screw 1/4 - 20 x 1-3/4	2	2	2
*		40086	Socket Set Screw 1/4 - 20 x 3/4	1	1	1
*		40646	Spacer	2	2	2
*		40268	Lock Washer 1/4	2	2	2
*		40093	Hex Nut 1/4 - 20	2	2	2
	3	41679	Latch Assembly	1	1	1
	4	41699	Door Bushing	4	4	4
	5	40646	Spacer	2	2	2
	6	41672	Door Panel	1		
		41670	Door Panel		1	
		41671	Door Panel			1
	7	41658	Door Gasket	1		
		41656	Door Gasket		1	
		41657	Door Gasket			1
	8	41665	Gasket Plate	1		
		41663	Gasket Plate		1	
		41664	Gasket Plate			1
	9	41698	Hinge Rod	1		
		41696	Hinge Rod		1	
		41697	Hinge Rod			1
*	10	40369	Steam Diverter	2	2	2

PARTS LIST, COUNTER CONVECTION STEAMERS  
MODELS SN-3E, SN-4E, SN-5E

	<u>ITEM</u>	<u>Part #</u>	<u>DESCRIPTION</u>	<u>3</u>	<u>4</u>	<u>5</u>
	11	42285	Actuator Complete With Retaining Rings	1	1	1
*		42137	Door Switch	1	1	1
	12	41631	Striker	1	1	1
*		41632	Stainless Steel Washer	1	1	1
*		40112	Lock Washer	1	1	1
*		40114	Nut	1	1	1
	13	40946	Pilot Light, green	1	1	1
	14	40951	Pilot Light, red	1	1	1
**	15	42456	Timer Dial - 60 Minutes, 50 Hz, Optional	1	1	1
		43265	Timer Dial - 60 Minutes, 60 Hz	1	1	1
		43266	Timer Dial - 120 Minutes, 60 Hz, Optional	1	1	1
	16	41886	Power Switch	1	1	1
*	17	43267	Label, De-Lime (rear of unit)	1	1	1
**	18	42893	Control Decal	1		
		42911	Control Decal - Continuous Steam, Optional	1		
		42896	Control Decal		1	
		42912	Control Decal - Continuous Steam, Optional		1	
		43268	Control Decal			1
		42913	Control Decal - Continuous Steam, Optional			1
	19	40244	Component Mounting Board	1	1	1
**	20	40625	Level Control Board, 10K OHM	1	1	1
		41064	Level Control Board, 1M OHM	2	2	2
	21	41887	Thermostat-Operating	1	1	1
	22	41888	High Limit Thermostat	1	1	1
	23	42094	Relay-Single Pole 240V	1	1	1
	24	42092	Relay-Double Pole 240V	1	1	1
**	25	40971	Timer, 60 Minutes, 240V	1	1	1
		40973	Timer, 120 Minutes, 240V, Optional	1	1	1
*		41881	Rotary Shaft Seal	1	1	1
	26	40852	Buzzer 240V	1	1	1
**	27	40892	Contactor - 4 Pole	1	1	1

PARTS LIST, COUNTER CONVECTION STEAMERS  
MODELS SN-3E, SN-4E, SN-5E

	<u>ITEM</u>	<u>Part #</u>	<u>DESCRIPTION</u>	<u>3</u>	<u>4</u>	<u>5</u>
		40943	Contactora - 380, 415, 480, 600 Volt	1	1	1
	28	41037	Cooling Solenoid 240V	1	1	
		40307	Cooling Solenoid 240V			1
	29	41037	Fill Solenoid 240V	1	1	1
	30	40602	Blow-down Solenoid 240V	1	1	1
**	31	41718	Element Assembly, 7.5 kW, 208V	1		
		41719	Element Assembly, 7.5 kW, 220/380V	1		
		41720	Element Assembly, 7.5 kW, 240/415V	1		
		41721	Element Assembly , 7.5 kW, 480V (287)	1		
		41722	Element Assembly , 7.5 kW, 600V (347)	1		
		41636	Element Assembly, 10 kW, 208V	1	1	
		41642	Element Assembly, 10 kW, 220/380V	1	1	
		41637	Element Assembly, 10 kW, 240/415V	1	1	
		41638	Element Assembly , 10 kW, 480V (287)	1	1	
		41722	Element Assembly , 10 kW, 600V (347)	1	1	
		41639	Element Assembly, 15 kW, 208V			1
		41639	Element Assembly, 15 kW, 220/380V			1
		41641	Element Assembly, 15 kW, 240/415V			1
		41643	Element Assembly , 15 kW, 480V (287)			1
		41724	Element Assembly , 15 kW, 600V (347)			1
	32	41703	Element Gasket	1	1	1
	33	40708	Terminal Block	4	4	4
	34	40707	End Section	1	1	1
	35	40840	Ground Lug	1	1	1
		42013	Earth I.D. Tag			
	36	41297	Steam Generator Tank	1	1	1
*	36	40234	Tank Cover	1	1	1
*		42138	Tank Gasket	1	1	1
	37	40469	Probe - 5" Low Level Cut Off	1	1	1
	38	40468	Probe - 4.25" Low Level	1	1	1
	39	40931	Probe - 3.6875" High Level	1	1	1

PARTS LIST, COUNTER CONVECTION STEAMERS  
MODELS SN-3E, SN-4E, SN-5E

	<u>ITEM</u>	<u>Part #</u>	<u>DESCRIPTION</u>	<u>3</u>	<u>4</u>	<u>5</u>
	40	41633	Perforated Trough	1	1	1
	41	40441	Elbow 1/4 c x 1/8 MPT	1	1	1
	42	40457	Tee 3/8c x 1/8 MPT	1	1	1
	43	40424	Connector 1/4 c x 1/8 MPT	1	1	1
	44	40435	Connector 1/2 c x 3/4 MPT	1	1	1
	45	40450	Elbow 1/2 c x 3/4 MPT	1	1	1
	46	40205	Thermostat Fitting, 3/8 c x 3/8 MPT	1	1	1
	47	40406	Union Coupling 1/2 c	1	1	1
	48	41047	Right Hand Steam Jet Tube	1	1	1
*		41048	Left Hand Steam Jet Tube	1	1	1
	49	40447	Elbow 1/2 c x 1/4 MPT	2	2	2
	50	40411	Elbow 1/2 c	1	1	1
	51	40475	Water Connection 3/8 c	1	1	1
	52	40076	Screw 10-32 x 1/2 SS	6	6	6
	53	41875	Screw (Special) 10-32 x 1/2	6	8	8
*	54	41864	Continuous Steam Switch (Optional)	1	1	1
	55	42905	Left Hand Side and Back	1		
		42906	Left Hand Side and Back		1	
		42907	Left Hand Side and Back			1
*	55	41856	Nut Cage, 1/4 - 20	2	2	2
	56	42390	Top	1	1	1
**	57	42338	Side Panel	1		
		42339	Side Panel		1	
		42340	Side Panel			1
**	58	40199	Rack Slides	2		
		40200	Rack Slides		2	
		40201	Rack Slides			2
*	59	40843	Rack Pin Assembly	4	4	4
	60	43269	Brass Nipple, 1/2 -14	1	1	1
	61	43270	Brass Elbow, 1/2-14	1	1	1
	62	43271	Square Head Brass Plug, 1/2 - 14	1	1	1

PARTS LIST, COUNTER CONVECTION STEAMERS  
MODELS SN-3E, SN-4E, SN-5E

	<u>ITEM</u>	<u>Part #</u>	<u>DESCRIPTION</u>	<u>3</u>	<u>4</u>	<u>5</u>	
	63	40429	Connector, 3/8 c x 1/8 MPT	1	1	1	
	64	43272	Connector, 3/8 c x 1/8 FPT	1	1	1	
	65	40445	Elbow 90°, 3/8 c x 3/8 MPT	1	1	1	
	66	41102	Pressure Switch	1	1	1	
	67	40669	Foot Leveler	4	4	4	
	68	43273	Adjustable Leg, Optional	4	4	4	
*	**	69	41860	Fuse 2 Amp. 250V (208, 240V)	2	2	2
			41860	Fuse 2 Amp. 250V (220, 220/380, 240/415)	1	1	1
			41844	Fuse Holder (208, 240V)	2	2	2
			41844	Fuse Holder (220, 220/380, 240/415V)	1	1	1
			41766	Fuse 1 Amp, 600V (380, 415, 480)	2	2	2
			41768	Fuse, 8/10 Amp, 600V (600V)	2	2	2
	69	41769	Fuse Holder (380, 415, 480, 600V)	2	2	2	
*	**	70	40974	Transformer, 380/220V, 50/60Hz, 100VA	1	1	1
			40974	Transformer, 415/240V, 50/60Hz, 100VA	1	1	1
			40980	Transformer, 480/240V, 60Hz, 100VA	1	1	1
			40985	Transformer, 600/240V, 60Hz, 100VA	1	1	1
	71	40097	Hex Blot 5/16-18 x 1 SS	2	2	2	
	72	40093	Hex Nut 1/4 - 20 SS	4	4	4	
*	73	41725	"Y" Strainer, Optional	1	1	1	
	74	42793	Compartment Strainer	1	1	1	
*	75	40683	Wire Harness	1	1	1	
	76	41114	Copper Tube, 3/8	1	1	1	

\* NOT SHOWN.

\*\* SELECT AS REQUIRED.